

2014 International Conference

UNESCO CHAIR IN TECHNOLOGIES FOR DEVELOPMENT: WHAT IS ESSENTIAL?

4-6 June 2014 | EPFL, Lausanne, Switzerland

PRACTICAL GUIDE

How to Get to Lausanne

Participants are kindly requested to make their own transport arrangements both from the airport/railway station to their hotels and to the conference venue.

Travel to Lausanne

Lausanne is located 60 km northeast of Geneva, and 225 km southwest of Zurich. The easiest way to reach Lausanne from either the Geneva-Cointrin International Airport or the Zurich Kloten International Airport is by train.

✓ **Getting to Lausanne from Geneva Airport:** Once you have cleared customs, turn left and follow the signs to the Airport's railway station. Tickets to Lausanne can be bought at the counters and ticket machines on the right hand side as you enter the station through a revolving door. The train from Geneva Airport to Lausanne takes about 45 minutes (there are 4 direct trains per hour without changing). A one-way train ticket from Geneva Airport to Lausanne costs CHF 26.-

✓ **Getting to Lausanne from Zurich Airport:** Lausanne is about 2:30 hours from Zurich Airport (there are 2 direct trains per hour without changing). There are also indirect trains that will require changing in Zurich city, Bern or Biel/Bienne. No matter what you choose, the price stays the same and the duration of the travel does not vary much. A one-way train ticket from Zurich Airport to Lausanne costs CHF 74.-

✓ The train schedules can be consulted at: <http://www.sbb.ch/en/home.html>

- It is not necessary to book the train, there is always enough place ...
- The price for a round-trip ticket will be exactly twice the price of a one-way ticket, so you can buy your ticket immediately or when you return, it does not matter. The price of the ticket does not vary depending on the time of the day.



Travel in Lausanne

Visitors staying in most hotels in Lausanne receive free travel cards for Lausanne buses and metro. The city center of Lausanne is a short distance from the train station: 2 minutes by metro, 5 minutes by bus or 10-15 minutes (uphill) by foot. The main metro stop for the city center is Lausanne-Flon ● where the m1 and m2 metro lines intersect. Lausanne lakeside can be reached from the railway station by metro m1 direction "Ouchy" ● in 5 minutes.

Travel to EPFL and the Swiss Tech Convention Centre

The EPFL campus is located 6 km west of Lausanne and is accessed easily by metro.

- ✓ **Public Transport:** If you come directly from the **main railway station** (Lausanne Gare CFF), take the metro line m2 to Lausanne-Flon (direction Croisettes), then change to metro line m1 (direction Renens). The ride on the m1 metro line from Lausanne-Flon to stop EPFL takes 12 minutes (direction: Renens or Renens-Gare).

NB: Tickets for the bus and metro lines in Lausanne should be purchased prior to boarding, from machines located at each bus/metro stop (make sure to have coins, as bills or credit cards are often not accepted). A single ticket costs CHF 2.20 for zone 11 (just for the city) and CHF 3.- for zones 11-12 (to reach EPFL from the city), and will be valid for 1 hour (from the time of purchase) of unlimited travel on any method of transport (bus, metro, local train) within the zone. Note, however, that most hotels provide day passes to their guests.

- ✓ **By Car:** On Motorway A1, follow the directions for Lausanne, then for Lausanne-Sud, and finally exit at "Sortie UNIL-EPFL". The lake will be on your left. At the second roundabout, after a few hundred meters, enter the EPFL campus on your right.

NB: Parking on campus is payable and as there are very few spaces available, we strongly recommend that you use public transport.

- ✓ **By Taxi:** Tell the driver you would like to go to the "Swiss Tech Convention Center". From the main railway station (Lausanne Gare CFF) the trip takes between 15 to 20 minutes, and normally costs between CHF 33.- to CHF 36.- (depending on traffic). From the Renens train station (Renens Gare CFF), the cost ranges from CHF 19.- to CHF 24.-

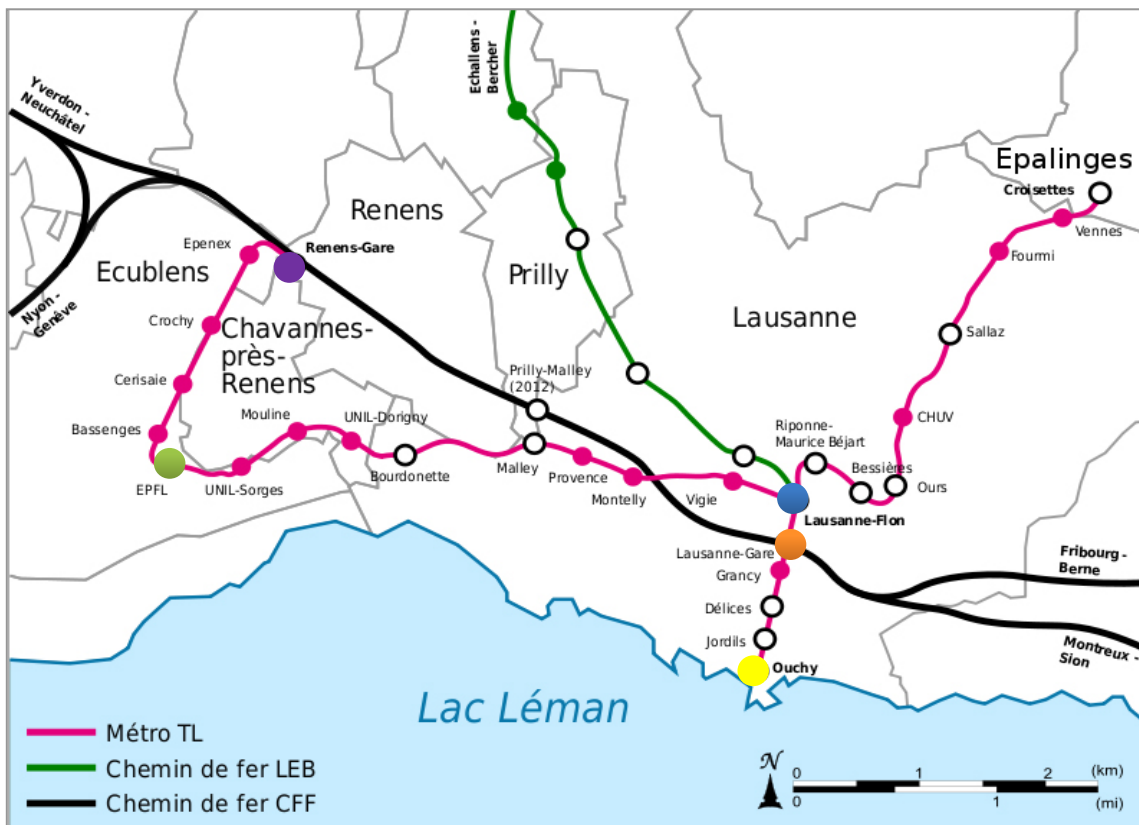

Conference Venue



Swiss Tech Convention Centre
Route Louis Favre 2
1024 Ecublens/Lausanne
Tel: +41 21 693 42 42 / 42 68
www.tstcc.ch



Swiss Tech Hotel
Route Louis-Favre 10b
1024 Ecublens
Tel: +41 21 694 06 10
Fax: +41 21 694 06 11
Email: sth@epfl.ch

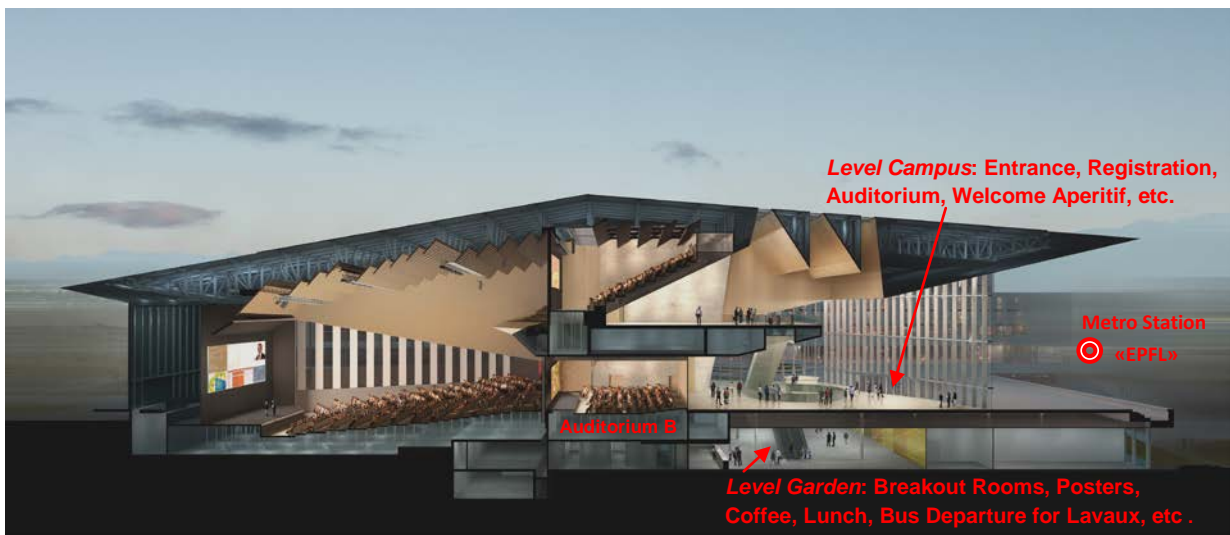

Conference Logistics

Registration and Conference Documents

The Registration Desk will open on Wednesday 4 June from 10:00 am onwards.

Upon arrival all participants (whether they are already registered and have paid the conference registration fees or walk-in) are kindly requested to present themselves at the Conference Registration Desk in the hall of the Swiss Tech Convention Centre to collect their badge and documents.

The sessions on Thursday afternoon will be hosted in the Lavaux Vineyards, followed by a social event in the village of Epesses. For logistical reasons, attendees will be asked to register for the relevant sessions at the Registration Desk in the morning on 4 or 5 June. In order not to hold up the process, please choose your session before you arrive for registration. Due to space limitations, registrations for the sessions will be taken on a first come, first served basis.

Participants are requested to wear their badges at all times during the Conference.

Walk-in Registration

On-site registration during the conference days is possible; however, payment of the conference fees must be made in cash (CHF only). For further information, see http://cooperation.epfl.ch/2014Tech4Dev/Register_Paymt.

Organization of Poster Presentations

The posters do not have to be sent in advance; please take your poster along on the first day of the conference or registration and display it on the panel that corresponds to the number indicated in the summary attached.

Material to set up your poster will be provided by the conference organizers at the time of your registration.

The posters will be displayed throughout the 3 days and presenters are asked to be available during the coffee and lunch breaks to discuss their work.

Organization of Breakout Sessions

In order to keep the sessions running on schedule, your presentation will be pre-loaded on the session computer. Speakers are not allowed to use their own personal laptop.

Please remember that your PowerPoint presentation should be sent to your Session Leader, with a copy to Tech4Dev@epfl.ch **no later than 25 May 2014**. No exceptions ...!

File name format should be ORAL_Tech4Dev2014_Last Name First Name (e.g., ORAL_Tech4Dev2014_Last Name First Name).

All breakout session rooms are equipped with a computer and a beamer. In each of the breakout sessions, a conference staff member will be present to assist the session leaders. A laser pointer will be available during the presentations.

Organization Sessions Thursday Afternoon and Social Event in the Lavaux Vineyards

The sessions on Thursday afternoon will be hosted in the Lavaux Vineyards, followed by a social event in the village of Epesses.

Lavaux is located in the Canton of Vaud, in the heart of French-speaking Switzerland. The Lavaux Vineyards have been part of the UNESCO World Heritage Programme since 2007. The vineyard terraces of 830 hectares cover the vertiginous shores of Lac Lemman between Montreux and Lausanne and offer one of the most beautiful panoramas in the world. They comprise 400 kilometers of walls and 10,000 terraces spread over 40 levels. This cultural landscape, worked since the 11th century, constitutes Switzerland's largest vineyards and encompasses 14 well-preserved villages. The Lavaux Vineyards mainly produce Chasselas wines, which are fruity and dry with subtle aromas.

We hope that you will be able to join us to experience the splendor of the region!

Important Logistical Information!

Registration for the Afternoon Sessions

- Due to limited space, it is essential that attendees register for the relevant sessions at the Registration Desk in the morning on 4 or 5 June. **Registrations will be taken on a first come, first served basis!**

Departure from EPFL for the Afternoon Sessions

- Busses for the breakout sessions will leave **at 14:00 precisely** in front of the SwissTech Convention Centre. Staff in red T-shirts holding a sign with the session name will be available to guide you to the right bus. Your conference badge should be worn at all times.
- Once the afternoon sessions are finished, guides will accompany you to Epesses.

Departure from EPFL for the Cocktail Reception in Epesses

- Conference participants who will not be attending the afternoon sessions in Lavaux, and accompanying guests, can catch the bus leaving **at 16:30 precisely** in front of the SwissTech Convention Centre [Route Louis Favre 2 – Ecublens].

Attire

- To add color to the event, attendees are encouraged to wear their national dress.

Return to Lausanne after the Cocktail Reception in Epesses

- At the end of the evening, attendees will return by train to Lausanne Main Station either at 19:47 or at 20:47 (journey time 15 minutes).
- Staff wearing red T-shirts will be posted at strategic locations to handle the necessary distribution of train tickets as well as provide any assistance required.
- Please note that the train station in Epesses is some 10 minutes on foot from where the Cocktail Reception will be hosted.

Accompanying Guests

- Accompanying guests (non-registered conference participants) are welcome to join us for the cocktail reception in Epesses at an additional cost of CHF 50.-/person payable in cash at the Registration Desk.
- Please be sure to register your guest at the Registration Desk in the morning on 4 or 5 June. Your guest will receive a badge which should be worn at all times.
- Guests will need to catch the bus leaving **at 16:30 precisely** in front of the SwissTech Convention Centre [Route Louis Favre 2 – Ecublens].

Thursday 5 June – Afternoon Sessions and Social Event Lavaux Vineyards – UNESCO World Heritage Site

.....>
1st DEPARTURE – BREAKOUT SESSIONS IN:
ARAN, GRANDVAUX, CULLY, RIVAZ AND CHEXBRES

...->
2nd DEPARTURE TO: EPESES

→ (RIVAZ,) →
GUIDED VISIT OF WINE CELLARS
AND COCKTAIL RECEPTION IN: EPESES

|||||
RETURN BY CFF TRAIN TO: LAUSANNE (MAIN STATION)

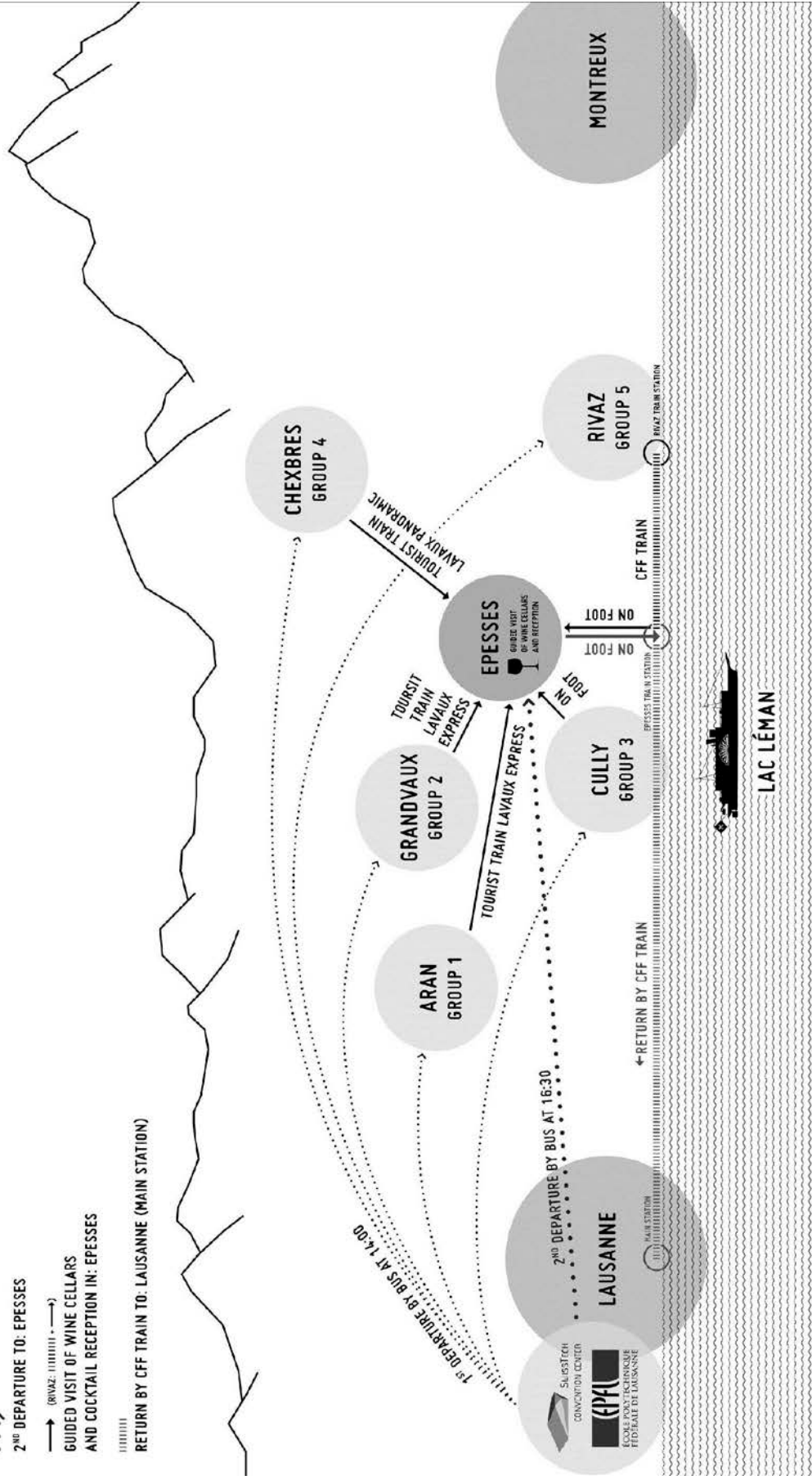

PROGRAMME – DAY 1 – Wednesday 4 June 2014 – Afternoon

Time	Program / Details / Key Persons	Location
10:00 onwards	Registration opens Welcome Coffee	SwissTech
12:30-13:30	Standing Lunch Poster Session	Level Garden SwissTech
13:30-14:30	Welcome Address <ul style="list-style-type: none"> • Prof. Philippe Gillet, Ecole Polytechnique Fédérale de Lausanne • Dr. Jean-Bernard Münch, Swiss Commission for UNESCO 	Auditorium B Level Campus SwissTech
	Keynote Address <ul style="list-style-type: none"> • Dr. Shashi Buluswar, LIGTT: LBNL Institute for Globally Transformative Technologies, Lawrence Berkeley National Lab, United States 	
14:30-17:00	TH1-SE01-01 Habitat Water and Sanitation Technologies for Sustainable Urban Development <ul style="list-style-type: none"> • Dr. Christian Zurbrügg, Department of Water and Sanitation in Developing Countries (SANDEC), Eawag: Swiss Federal Institute of Aquatic Science and Technology, Switzerland • Dr. Hung Nguyen-Viet, Center for Public Health and Ecosystem Research (CENPHER), Hanoi School of Public Health, Vietnam 	Room 3C Level Garden SwissTech
	TH2-SE02-01 DRR Developing Appropriate Contexts for Successful Deployment of Essential Technologies for Disaster Risk Reduction <ul style="list-style-type: none"> • Ms. Marie-Valentine Florin, International Risk Governance Council (IRGC), Switzerland 	Room 4C Level Garden SwissTech
	TH2-SE02-05 Energy Up-Scaling Sustainable Pro-Poor Energy Solutions: Addressing Stumbling Blocks <ul style="list-style-type: none"> • Dr. Albrecht Ehrensperger, Centre for Development and Environment, University of Bern, Switzerland • Dr. Lucy Stevens, Practical Action, United Kingdom 	Room 5C Level Garden SwissTech
	TH2-SE02-11 ICT The Openness Paradigm: How Synergies Between Open Access, Open Data, Open Science, Open Source Hardware, Open Drug Discovery Approaches Support Development? <ul style="list-style-type: none"> • Dr. Sachiko Hirose, School of Life Sciences, Ecole Polytechnique Fédérale de Lausanne, Switzerland • Dr. Denisa Kera, National University of Singapore 	Room 1A Level Garden SwissTech
	TH2-SE02-17 Medical Appropriate Medical Devices: From Lab to Bedside in Resource-Constrained Contexts <ul style="list-style-type: none"> • Dr. Klaus Schönenberger, EssentialTech Programme, Cooperation & Development Center, Ecole Polytechnique Fédérale de Lausanne, Switzerland 	Room 1C Level Garden SwissTech
	TH3-SE03-05 Special Sess. Development Engineering: A Unified Approach to Tech4Dev <ul style="list-style-type: none"> • Dr. Temina Madon, Development Impact Lab, University of California Berkeley, United States 	Room 2C Level Garden SwissTech
15:45-16:15 Coffee Break	BREAKOUT SESSIONS	
17:00-18:00	Welcome Aperitif <ul style="list-style-type: none"> • Prof. Laurent Goetschel, University of Basel, Switzerland • Dr. Christian Zurbrügg, SANDEC, Eawag, Switzerland 	Auditorium B Level Campus SwissTech
	<i>Event hosted by the Commission for Research Partnerships with Developing Countries (KFPE), Switzerland</i>	Hall SwissTech

PROGRAMME – DAY 2 – Thursday 5 June 2014 – Morning

Time	Program / Details / Key Persons	Location	
08:30 onwards	Walk-in Registration Welcome Coffee	SwissTech	
09:00-10:00	Return of Sessions Day 1 Keynote Address <ul style="list-style-type: none"> • Dr. Jean-Yves Pidoux, City of Lausanne • Prof. Karen Scrivener, Laboratory of Construction Materials, Ecole Polytechnique Fédérale de Lausanne 	Auditorium B Level Campus SwissTech	
10:00-10:30	Coffee Break	Level Garden	
BREAKOUT SESSIONS	10:30-12:30	TH2-SE02-06 Energy What are the Techno-socio-economic Aspects that are Influencing the Success of the Development, Implementation, Maintenance and Spreading of Appropriate Technologies for Access to Energy ? <ul style="list-style-type: none"> • Mr. Bertrand Klaiber, Cooperation & Development Center, Ecole Polytechnique Fédérale de Lausanne, Switzerland 	Room 1C Level Garden SwissTech
	TH2-SE02-07 Habitat Community-Driven Innovation: Communicating Living Labs Essentials in the Developing World <ul style="list-style-type: none"> • Ms. Tunde Kallai, Prolog GmbH, Switzerland, European Network of Living Labs (ENoLL) • Mr. Konte Papa Amadou, Dakar City Municipality, Senegal 	Room 2C Level Garden SwissTech	
	TH2-SE02-13-a ICT How can we Co-design Technologies (and not for) Vulnerable and Poor Communities? <ul style="list-style-type: none"> • Dr. Andrés Felipe Valderrama Pineda, Aalborg University, Denmark • Dr. Maria Catalina Ramírez, Universidad de los Andes, Colombia 	Room 3C Level Garden SwissTech	
	TH2-SE02-14 Medical Technology in Global Health: Exploring New Paradigms <ul style="list-style-type: none"> • Dr. Leo Anthony Celi, Harvard Medical Institute, Massachusetts Institute of Technology, United States • Dr. Vipin Nikore, Cleveland Clinic Foundation, United States 	Room 5C Level Garden SwissTech	
	TH3-SE03-02 ICT Tools and Techniques for Measuring Technology Impact: From Wireless Sensors to Experimental Field Trials <ul style="list-style-type: none"> • Prof. Ashok Gadgil, Lawrence Berkeley National Lab, University of California Berkeley, United States 	Room 4C Level Garden SwissTech	
12:30-13:30	Standing Lunch Poster Session	Level Garden SwissTech	
13:30-14:00	Introduction to the Terraced Vineyards of Lavaux Mr. Emmanuel Estoppey, Lavaux UNESCO World Heritage Site	Auditorium B Level Campus SwissTech	
14:00-14:30	Departure of the Busses from the SwissTech Convention Centre to 5 sites in Lavaux where the breakout sessions will be hosted <i>Note: Staff in red T-shirts holding a sign with the session name will be available to guide you to the right bus. Please be sure that you get on the right bus of the session that you wish to attend! Your conference badge should be worn at all times.</i>	Level Garden SwissTech	

PROGRAMME – DAY 2 – Thursday 5 June 2014 – Afternoon

Time	Program / Details / Key Persons	Location
BREAKOUT SESSIONS	14:30-16:30 TH1-SE01-02 Habitat What Technologies are Essential for Megacities of the Future to be Sustainable? <ul style="list-style-type: none"> • Dr. Justin Bishop, Department of Engineering, University of Cambridge, United Kingdom 	Breakout Sessions: Aaran, Grandvaux, Cully, Chexbres, Rivaz Visit Wine Cellars & Cocktail Reception: Epesses LAVAUX – UNESWORLD HERITAGE SITE
	TH2-SE02-02 DRR Politics, Society and Technology Integration: How Does Policy Making Affect Governmental and Local Use of ICTs for Disaster Risk Reduction? <ul style="list-style-type: none"> • Dr. Paula Lytle, The World Bank, United States • Mr. Charles Martin-Shields, Ministry of Communications and Information Technology, Independent Samoa 	
	TH2-SE02-03 Energy Up-Scaling and Mainstreaming Renewable Energy Technologies for Energy Security, Climate Change and Economic Development <ul style="list-style-type: none"> • Dr. Pankaj Agarwal, Panitek AG, Liechtenstein • Dr. Kinsuk Mitra, InsPIRE Network for Environment, India 	
	TH2-SE02-15 Medical Facilitating and Stimulating Inclusive Design and Innovation <ul style="list-style-type: none"> • Prof. Prabhu Kandachar, Faculty of Industrial Design Engineering, Delft University of Technology, Netherlands 	
	TH3-SE03-04 ICT Sustainable Development of Technology Solutions in Emerging Countries: Case Studies <ul style="list-style-type: none"> • Ms. Jennifer Brant, Innovation Insights, Switzerland 	
16:30-17:00 Guided Tour of the Lavaux Region <i>Guides from the UNESCO World Heritage Site will oversee and accompany the 5 groups to give further details on Lavaux's history, wealth and heritage</i>	Group 1 – From Aran to Epesses => Tourist Train Lavaux Express Group 2 – From Grandvaux to Epesses => Tourist Train Lavaux Express Group 3 – From Cully to Epesses => On foot Group 4 – From Chexbres to Epesses => Tourist Train Lavaux Panoramic Group 5 – From Rivaz to Epesses => Train CFF	
16:30	Departure of the Bus from the SwissTech Convention Centre for the Cocktail Reception in Epesses <i>(for those not attending the breakout sessions in the afternoon)</i>	Level Garden SwissTech
From 17:00	Visit of the Wine Cellars in Epesses (Lavaux) Cocktail Reception – Mix & Mingle	Epesses
19:47 or 20:47	Return by Train to Lausanne Main Station	

PROGRAMME – DAY 3 – Friday 6 June 2014 – Morning

Time	Program / Details / Key Persons	Location		
08:30 onwards	Walk-in Registration Welcome Coffee	SwissTech		
09:00-10:00	Return of Sessions Day 2	Auditorium B Level Campus SwissTech		
	Keynote Address • Dr. Anil Sethi, Swiss Extension GmbH			
10:00-10:30	Coffee Break	Level Garden SwissTech		
BREAKOUT SESSIONS	10:30-12:30	TH1-SE01-03 Energy	Identifying Opportunities and Constraints for Women in the Renewable Energy Sector • Dr. Bipasha Baruah, Department of Women's Studies and Feminist Research, University of Western Ontario, Canada • Dr. Mini Govindan, Social Transformation Division, The Energy and Resource Institute (TERI), India	Room 2C Level Garden SwissTech
	10:30-12:30	TH2-SE02-08 Habitat	Implementing Living Labs Concepts to Strengthen the Innovation Ecosystem for Social Innovation in Rural Areas and Cities • Dr. Hans Schaffers, Center of Knowledge and Innovation Research (CKIR), Aalto University, Finland	Room 3C Level Garden SwissTech
	10:30-12:30	TH2-SE02-10 ICT	Low-Cost, High-Tech and Crowd-Sourced Solutions for Better Water Management – Opportunities and Challenges • Dr. Tobias Siegfried, hydrosolutions Ltd., Switzerland • Mr. François Münger, Corporate Domain Global Cooperation, Swiss Agency for Development and Cooperation (SDC), Switzerland	Room 5C Level Garden SwissTech
	10:30-12:30	TH2-SE02-13-b ICT	How can we Co-design Technologies (and not for) Vulnerable and Poor Communities? • Dr. Andrés Felipe Valderrama Pineda, Aalborg University, Denmark • Dr. Maria Catalina Ramirez, Universidad de los Andes, Colombia	Room 1C Level Garden SwissTech
	10:30-12:30	TH2-SE02-16 Medical	Strategies for the Successful Implementation of Mobile Health (mHealth) in Low-Resource Settings • Dr. Walter Karlen, Stellenbosch University, South Africa and University of British Columbia, Canada	Room 4C Level Garden SwissTech
	10:30-12:30 *	Water Hackathon & Workshop	Water Hackathon: Open Source Technologies for Rivers, Oceans and Lakes • Ms. Gabriela Levine, Interactive Telecommunications Program Tisch School of the Arts, United States • Mr. Nur Akbar Arofattullah, Gadjah Mada University, Indonesia	Room 3A Level Garden SwissTech
12:30-13:30	Standing Lunch Poster Session	Level Garden SwissTech		

* The Water Hackathon starts at 10:30 am and continues in the afternoon until 15:00.

PROGRAMME – DAY 3 – Friday 6 June 2014 – Afternoon

	Time	Program / Details / Key Persons	Location
BREAKOUT SESSIONS	13:30-15:15	TH2-SE02-04 Energy Catalyzing Innovation through Targeted Scientific Training and Capacity Building • Prof. Federico Rosei, UNESCO Chair in Materials and Technologies for Energy Conversion, Saving and Storage, Institut National de la Recherche Scientifique (INRS), University of Quebec, Canada	Room 1C Level Garden SwissTech
	13:30-15:00	TH2-SE02-09 ICT Low Cost Data Communications for Sustainable and Environment Sound Development • Prof. Ermanno Pietroseoli, Abdus Salam International Centre for Theoretical Physics, Italy and Fundación “EsLaRed”, Venezuela	Room 3C Level Garden SwissTech
	13:30:15:00	TH2-SE02-18 Medical Medical Devices for the Base of the Pyramid: Where are they? • Mr. Zach Friedman, LIGTT: Institute for Globally Transformative Technologies, Lawrence Berkeley National Lab, University of California Berkeley, United States	Room 5C Level Garden SwissTech
	13:30-15:00 *	Water Hackathon & Workshop Water Hackathon: Open Source Technologies for Rivers, Oceans and Lakes (Cont.) • Ms. Gabriela Levine, Interactive Telecommunications Program Tisch School of the Arts, United States • Mr. Nur Akbar Arofattullah, Gadjah Mada University, Indonesia	Room 3A Level Garden SwissTech
	15:00-15:30	Coffee Break	Level Garden SwissTech
	15:30-17:00	Return of Sessions Day 3	Auditorium B Level Campus SwissTech
		Wrap-up and Closing • Dr. Silvia Hostettler, Cooperation & Development Center, Ecole Polytechnique Fédérale de Lausanne, Switzerland	

* The Water Hackathon starts at 10:30 am and continues in the afternoon until 15:00.

Poster Presentations – 4-6 June 2014 – Level Garden

Poster Number	Poster Presenter	Institution / Organization	Title of Poster
Disaster Risk Reduction			
DR1	Caimi, Annalisa	Ecole Nationale Supérieure d'Architecture de Grenoble (France)	From Local Building Practices to Vulnerability Reduction: Building Resilience through Existing Resources, Knowledge and Know-how
DR2	Hofmann, Milo	Ecole Polytechnique Fédérale de Lausanne (Switzerland)	Looking for 'Vernacular Paraseismic Building Workmanlike Manner'
DR3	Rist, Armin	Bern University of Applied Sciences (Switzerland)	How to Adapt the Integral Risk Management Concept as Applied in Switzerland for an Effective Implementation in Mountainous Developing Countries
DR4 DR5 DR6	Duyne Barenstein, Jennifer	University of Applied Sciences of Southern Switzerland (Switzerland)	Understanding the Impact of Changes in Building Technologies in Reconstruction After Natural Disasters
Energy			
ER1	Dhingra, Sunil	The Energy and Resources Institute (India)	Decentralized Distributed Generation for Rural Electrification in India: A Case of Two-Stage Biomass Gasifier
ER2	Huber, Christian	Oekozentrum – Centre of Appropriate Technology and Social Ecology (Switzerland)	Ecological Fruit-drying for Developing Countries
ER3	Mariun, Norman	Universitiy Putra Malaysia (Malaysia)	Modelling of 30 Megawatts Photovoltaic Generator Power Plant for Smart Grid Integration
ER4	Sharp, Kendra	Oregon State University (United States)	Development of Open-source Computational Tools for the Estimation of Future Water Availability in Data-Scarce Regions and Associated Micro-Hydro Power Potential
Habitat & Cities			
HA1	Bassan, Magalie	Eawag: Swiss Federal Institute of Aquatic Science and Technology (Switzerland)	Technologies for Sanitation Development: How to Determine Appropriate Sludge Treatment Strategies in Vietnam
HA2	Ganesa Pillai, Magesh	VIT University (India)	Development of Sustainable Sanitation Infrastructure for Processing Human Wastes and its Application as Organic Manure.
HA3	Kouamé, Parfait Koffi	Eawag: Swiss Federal Institute of Aquatic Science and Technology (Switzerland)	Improving the Waste Management Systems of Urban and Peri-Urban Areas: Material Flow Modeling of Nitrogen Impact and Environmental Sanitation Assessment in Yamoussoukro, Côte d'Ivoire
HA4	Gallegos, Angel	Polytechnic University of Catalonia (Spain)	Regeneration and Reuse of Runoff and Drainage Water in Agricultural Plots by Combined Natural Water Systems
HA5	Cvetinovic, Marija	Ecole Polytechnique Fédérale de Lausanne (Switzerland)	An Engine for Bottom-Up Urban Development in Action: A Case Study of Savamala Civic District
HA6	Cottino, Valeria	Architettura senza Frontiere Piemonte onlus (Italy)	Re-start from straw
Information & Communication Technologies			
IC1	Haemmig, Christoph	Geotest AG (Switzerland)	Early Warning and Hazard Assessment of Glacial Lake Outburst Floods, Yarkant River, P.R. China
IC2	Stoll, Sebastian	hydrosolutions Ltd. (Switzerland)	iMoMo - A Data Assimilation System for the Thembi Catchment, Tanzania
IC3	Rinderer, Michael	University of Zurich (Switzerland)	The "Boots & Trousers" Method: Qualitative Field Observations of Shallow Soil Moisture Patterns – An Extension to Dry Soils
IC4	Brant, Jennifer	Innovation Insights (Switzerland)	Improving SME Performance by Enhancing Appropriation
IC5	Tollefson, Sara	D-Rev: Design Revolution (United States)	Evaluating from a Distance: Measuring Impact of Market-based Interventions
IC6	Galati, Adriano	Disney Research (Switzerland)	Opportunistic Networking for Socio-Economic Empowerment in Developing Areas
IC7	Engelhardt, Jutta	The International Platform on Sport and Development (Switzerland)	Communications Platforms as an Essential Technology
IC8	Elkhadir, Awad	King Abdul Aziz University (Saudi Arabia)	Internet Use by Radiology Teachers and Students of King Abdulaziz University: An Analysis

Poster Presentations – 4-6 June 2014 – Level Garden (Cont.)

Poster Number	Poster Presenter	Institution / Organization	Title of Poster
Medical Technologies			
ME1	Payne, Beth	University of British Columbia (Canada)	PIERS (Pre-eclampsia Integrated Estimate of RiSk) on the move – development and evaluation of a mobile clinical decision aid for use in women with a hypertensive disorder of pregnancy
ME2	Loerup, Lise	University of Oxford (United Kingdom)	The 4P Study: Prediction of Physiological Patterns in Pregnancy using mHealth Technologies
ME3	Onu, Charles	The Fisher Foundation for Sustainable Development in Africa (Nigeria)	Harnessing Mobile Technology for the Diagnosis of Perinatal Asphyxia
ME4	Rosado, Luis	Fraunhofer AICOS (Portugal)	Mobile-based Detection of P. falciparum Malaria Parasites in Thick Blood Smears
ME5	Todd, Matthew	The University of Sydney (Australia)	Open Source Drug Discovery for Malaria
ME6	Estuar, Maria Regina Justina	Ateneo de Manila University (Philippines)	Stories from the Communities: Tracing User Behavior from Voices and Actions on Use of a Tablet Based Electronic Health Record and Data Visualization System for Public Health Service Delivery
ME7	Klugman, Noah	University of Michigan (United States)	Putting the IT in QUIT Smoking
ME8	Gani, Matthieu	Ecole Polytechnique Fédérale de Lausanne (Switzerland)	GlobalNeonat: An Appropriate Infant Incubator and Phototherapy Unit for Resource-Poor Settings
ME9	Sahli, Romain	Ecole Polytechnique Fédérale de Lausanne (Switzerland)	GlobalDiagnostiX: Appropriate Diagnostic Imaging for Resource-Poor Settings

General Information

► Credit Cards, Banking and Automats

Cash and travelers checks can be exchanged in the banks, at airports and railway stations and in most hotels. The most popular credit cards in Switzerland are VISA, MasterCard and Eurocard. The banks are generally open from Monday to Friday from 08:30 to 12:15, and from 13:30 to 16:30, and closed on Saturdays and Sundays. Automats issuing Swiss banknotes, available 7/7 and 24/24 accept the main cards and world networks (VISA, Eurocard/Mastercard, EC, Postcard, Maestro, Cirrus, Electron, Plus, Eufiserv, Cash). On campus "Credit Suisse" ATMs can be found at the shopping arcade next to the Swiss Tech Convention Centre, the Esplanade and the Rolex Learning Center.

► Climate

Situated between the Jura and the Alps, Lausanne enjoys a temperate climate. In June, average temperatures in the Lausanne area lie between 11°C and 22°C. Do try to bring a light waterproof coat and a warm sweater in case of rain or if you are susceptible to chilly evenings ...!

► Communications

The cost of local calls varies and is invoiced by the minute. For local as well as long distance calls, prepaid cards may be bought at post offices, kiosks, train stations or Swisscom shops. The international country dialing code for Switzerland is +41. The outgoing code is 00, followed by the relevant country code (e.g. 0091 for India). City/area codes are in use e.g. (0)21 for Lausanne, (0)22 for Geneva, etc.

► Currency

Banknotes: CHF 1000, 200, 100, 50, 20 and 10 / Coins: CHF 5, 2, 1 and 50, 20, 10 and 5 centimes. Prices are often indicated in Swiss Francs (CHF) and in Euro (EUR). The Euro is accepted by larger shops and service suppliers. Nevertheless, change will be given in Swiss Francs.

► Electricity

The voltage in Switzerland, as in most of Europe, is 230V/50 Hz. Switzerland uses type C (2-pin) and Type J (3-pin) plugs. Type C 2-pin plugs also fit J sockets. Type C is used in many countries (although not in most English speaking ones). Most "universal" adapter sets include this plug. A limited quantity of adapters will be on sale at the Conference Registration Desk should you forget to bring yours along with you!



► Post Offices

There are many post offices in Lausanne (Malley, Place Saint-François, CFF main railway station, Ouchy) as well as on the EPFL campus. In general, they are open Monday to Friday from 08:00 to 12:00 and 14:00 to 17:00, on Saturday until 12:00 and closed on Sunday. The cost of stamps for sending post cards and letters (up to 20 grams): In Europe: CHF 1.30 (normal) and 1.40 (priority); Outside Europe: CHF 1.60 (normal) and 1.90 (priority).

► Shopping

In the city centre of Lausanne there are many shops, all kinds are represented (fashion, watches, food, etc.). There is also an open market each Wednesday and Saturday morning. Most of the shops are open Monday to Friday from 08:00 to 19:00, on Saturday until 18:00 and closed on Sundays.

► Time

Local time in Switzerland is GMT +1 (GMT +2 between April to October).

► Safety Information

Switzerland has a low crime rate compared to other European countries and is generally a safe country to travel in, however there has been an increase in petty theft and visitors should be alert to pickpockets and thieves, particularly at the airport, in the city centers and on public transport.

► Liability

The conference organizers shall not be held liable for personal accidents, losses or damages to private property of registered participants of the conference. Participants should make their own arrangements with respect to personal insurance.